

SIDES Cape Feet		DIRECTIONS	CO-ORDINATES y System $L^{\circ}23'x$		OFF. DESIG.
		Constant	+200000.0	+11175000.0	
AB	11246.0	285. 5. 4	A + 44217.0	+ 55477.0	
BC	14713.5	16.36.22	B + 33358.5	+ 58403.7	
CD	16181.5	39.55.53	C + 37563.5	+ 72503.5	
DE	16352.5	151.41.30	D + 47949.9	+ 84911.7	
EF	11105.7	271.19.17	E + 55704.5	+ 70514.8	
FA	15298.7	181.26.27	F + 44601.7	+ 70770.9	

Signature
Surveyor-General.
28.11.1967

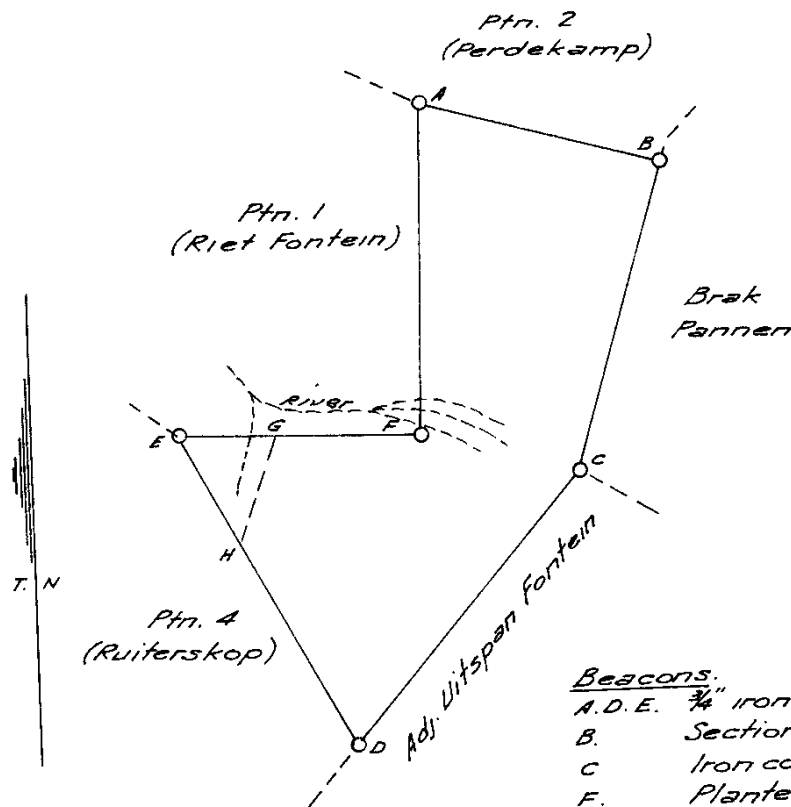

Beacons.
A.D.E. $\frac{3}{4}$ " iron peg in cairn
B. Section of fencing std. in
C. Iron corner fence post.
F. Planted stone proj. 3'

Scale 1:100000

The figure A.B.C.D.E.F.

represents 3107.0852 morgen of land, being

Portion 3 (Modderpoort)
of the farm Platfontein

situate in the

Administrative District of Beaufort West Province of Cape of Good Hope

Surveyed in August 1967 by me

Signature
Land Surveyor.

This diagram is annexed to

D/r No. 26602/67

dated

i.f.o.

Registrar of Deeds.

The original diagram is

No. 8353/1967

Transfer/Grant

No.

File No 5/12194.

S.R. No. E 2316/67

Comp. DL-7, CL-1.

Gen. Plan

OFFICE COPY
KANTOOR AFSKRIF

S.G. No.
8057/67

Approved.

[Signature]
Surveyor-General.
28.11.1967

SIDES Cape Feet		DIRECTIONS	CO-ORDINATES y System $L^{\circ}23'x$		OFF. DESIG.
		Constant	+200000.0	+11175000.0	
AB	12933.5	270. 4. 44	A + 73203.5	+ 65309.4	
BC	6910.5	318.38. 59	B + 60270.0	+ 65327.2	
CD	16352.5	331. 41. 30	C + 55704.5	+ 70514.8	
DE	9929.8	39.55. 53	D + 47949.9	+ 84911.7	
EF	1425.6	43.38. 50	E + 54323.5	+ 92526.0	
FG	24485.2	139. 15. 37	F + 55307.5	+ 93557.6	
GA	9883.8	168.49. 12	G + 71287.1	+ 75005.6	

Beacons

- A. 3' cairn.
B.C.D. $\frac{3}{4}$ " iron peg in cairn.
E.F. iron corner fence post.
G. 3' cairn.

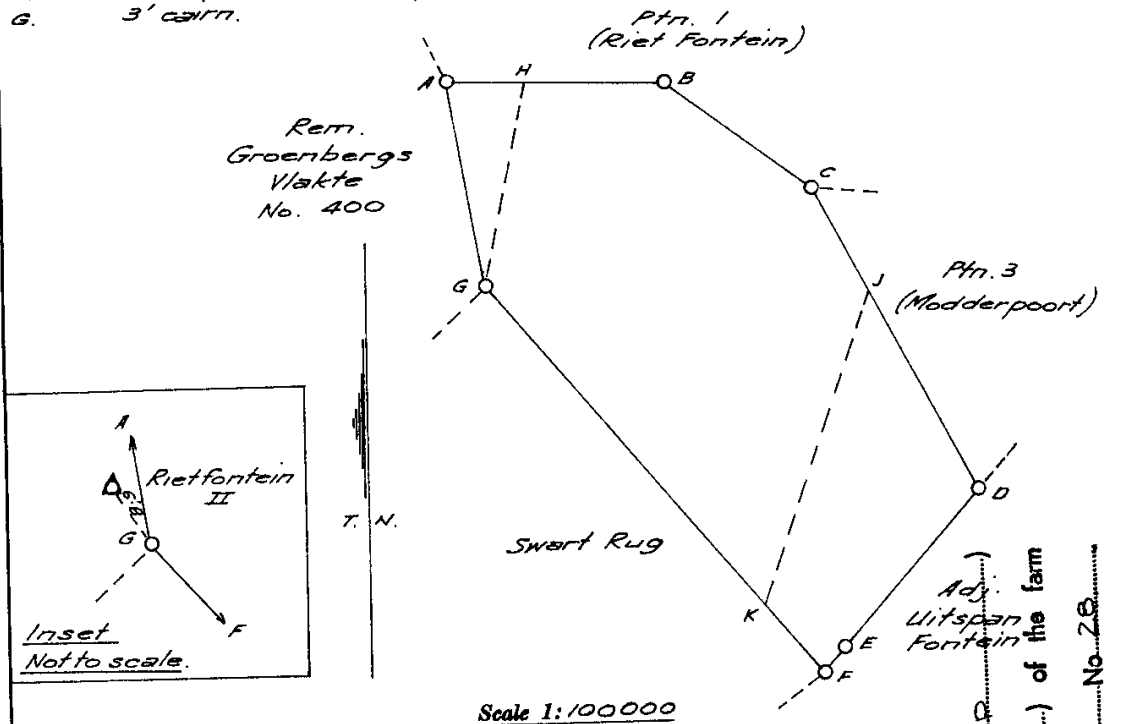

The figure A.B.C.D.E.F.G.

represents 4406.5388 morgen of land, being

Portion 4 (Ruiters Kop)
of the farm Platfontein

situate in the

Administrative District of Beaufort West Province of Cape of Good Hope

Surveyed in August 1967 by me

[Signature]
Land Surveyor.

This diagram is annexed to

No. 26603/68

dated

i.f.o.

Registrar of Deeds.

The original diagram is

No. 8353/1967

Transfer/Grant

No.

File No. S/12194.

S.R. No. E 2316/67

Comp. DL-7, CL-1.

Gen. Plan

OFFICE COPY
KANTOOR AFSKRIF

S.G. No.

8354/67

Approved.

Aggkdy
Surveyor-General.
28.11.1967

SIDES Cape Feet	DIRECTIONS	CO-ORDINATES y System $\angle 23^{\circ} \alpha$		OFF. DESIG.
		Constant		
AB 8876.8	290.38.42	A	+ 69807.6	+ 39132.9
BC 6517.1	329.51.41	B	+ 61500.8	+ 42262.7
CD 15929.6	298.24.24	C	+ 58228.6	+ 47898.8
DE 15298.7	126.27	D	+ 44217.0	+ 55477.0
EF 11105.7	91.19.17	E	+ 44601.7	+ 70770.9
FG 6910.5	138.38.59	F	+ 55704.5	+ 70514.8
GH 12933.5	90.4.44	G	+ 60270.0	+ 65327.2
HJ 5041.8	155.53.51	H	+ 73203.5	+ 65309.4
JK 782.9	209.57.10	J	+ 75262.4	+ 60707.2
KL 8007.4	213.47.55	K	+ 74871.5	+ 60028.8
LM 4834.4	161.58.00	L	+ 70417.2	+ 53374.7
MN 2087.2	238.26.34	M	+ 71913.7	+ 48777.8
NA 8558.8	182.11.37	N	+ 70135.2	+ 47685.4

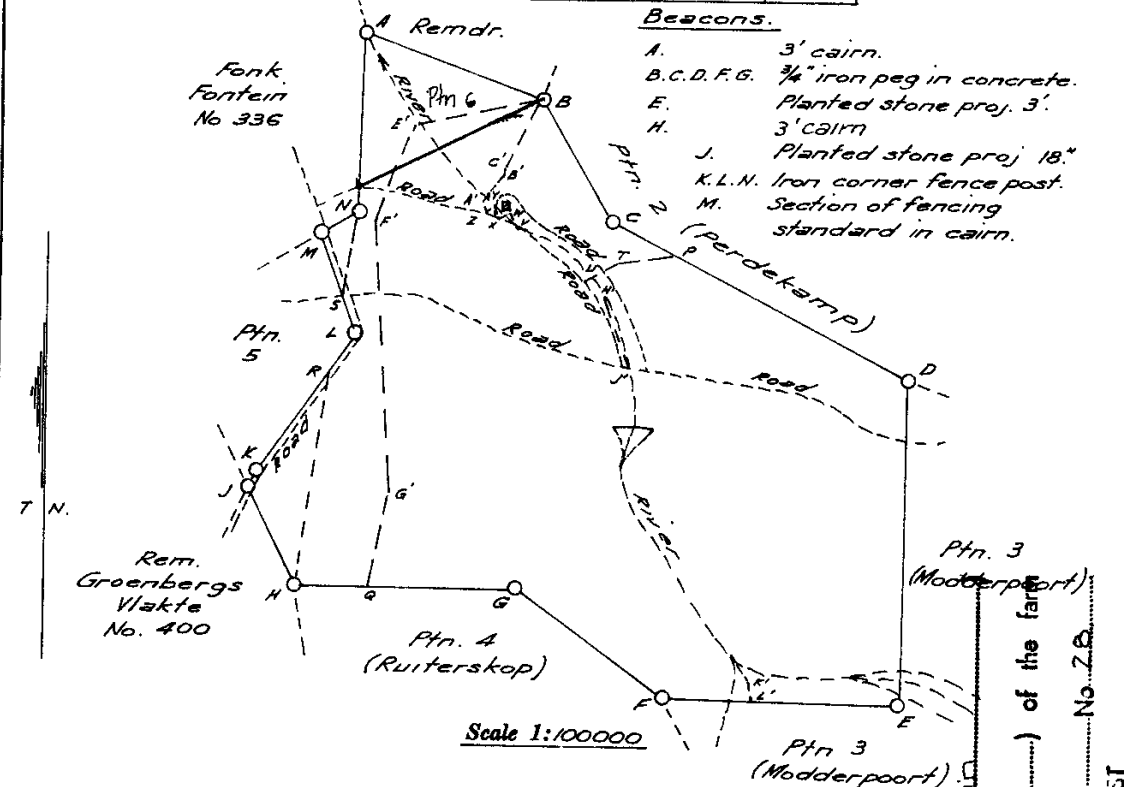

The figure A.B.C.D.E.F.G.H.J.K.L.M.N

represents 6755 6838 morgen of land, being

Portion 1 (Riet Fontein)
of the farm Platfontein

situate in the

Administrative District of Beaufort West Province of Cape of Good Hope

Surveyed in August 1967 by me

[Signature]
Land Surveyor.

This diagram is annexed to

2/ No. 26601/68

dated

i.f.o.

Registrar of Deeds.

The original diagram is

No. 8353/1967

Transfer/Grant

No.

File No. 5/12/34.

S.R. No. E 2316/67

Comp. DL-7, 1.

Gen. Plan

S.P.C.T.-8374

FOR ENDORSEMENTS
SEE PLAN OF DIAGRAM

SURVEY RECORD		DATE		TIME	
E1525/87	4865/87	PM	6	302, 8092	69581/88
					5/c

B. V. P. 14. 8.

Part 1. 2229/1874.
No. 347/1874.
D/G B.V. P. 14-8.

R

The Numerical data of this Diagram are sufficiently consistent.

2229
N 347, 1874 R.

J. M. M. M. M.
Examiner.

Roads and Water-runs sketched

Beacons pointed out to G. Kreugel F.C. division of Traraburg
G. V. de Westhuizen
C. du Toit

SIDES—CAPE ROADS.		ANGLES.	
AB	718.00	A	103. 21. 10
BC	2041.77	B	86. 5. 50
CD	455.81	C	88. 55. 40
DE	1134.43	D	112. 32. 30
EA	941.42	E	149. 4. 50

THE FARM Sweet Rug No. 88

BEAUFORT-WEST

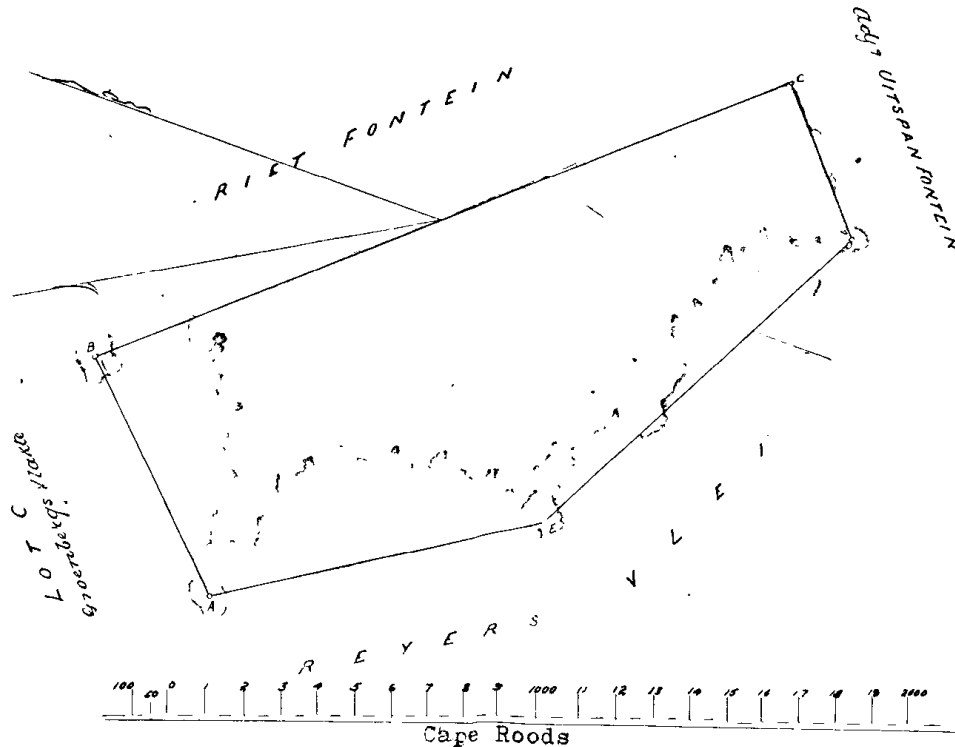

C S

B

md

JB.

I certify that this Diagram belongs to the...
in favour of G. V. de Westhuizen
18 Nov 1874
G. V. de Westhuizen
18 Nov 1874

THE FARM Swart Rug No. 88

BEAUFORT-WEST

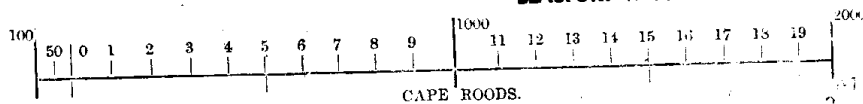

Part ²²²⁹ 2. ✓ *R*
No. 347/1874.
D/G B.W. Q. 14-8.

The above Diagram, coloured yellow, represents 2,427 Morgen 530 Square Rods of
CROWN LAND, being Lot No. 15 called SWART RUG
situated in the Fieldcornetcy of Ward No. 2 ~~GOUDH~~ ^{NIEUWEVELD}, Division of BEAUFORT,
Extending North to Orietfontein
South Reyers Vlei
East Ad. v. Uitspanfontein
West Lot C

Ch May 68
41 154

FRAMED FROM ACTUAL SURVEY.

Note.—Inspected 13 June 1873
Forwarded to Surveyor-General 21 Feb 1874
Area = 5130.71 Acres

J. A. Shraite
Government Surveyor.

Sheet CL-1.

SIDES Cape Feet	DIRECTIONS	CO-ORDINATES y System $\angle 23^{\circ}x$		OFF. DESIG.
		Constant	+200000.0 +11175000.0	
AB	4834.4 341.58.0	A	+ 71913.7 + 48777.8	
BC	8007.4 33.47.55	B	+ 70417.2 + 53374.7	
CD	782.9 29.57.10	C	+ 74871.5 + 60028.8	
DE	8484.4 155.53.51	D	+ 75262.4 + 60707.2	
EA	7995.9 238.26.34	E	+ 78727.2 + 52962.5	

[Signature]
Surveyor-General.
28.11.1967

Beacons.

- A. Section of fencing standard in cairn.
B.C.E. Iron corner fence post.
D. Planted stone proj. 18"

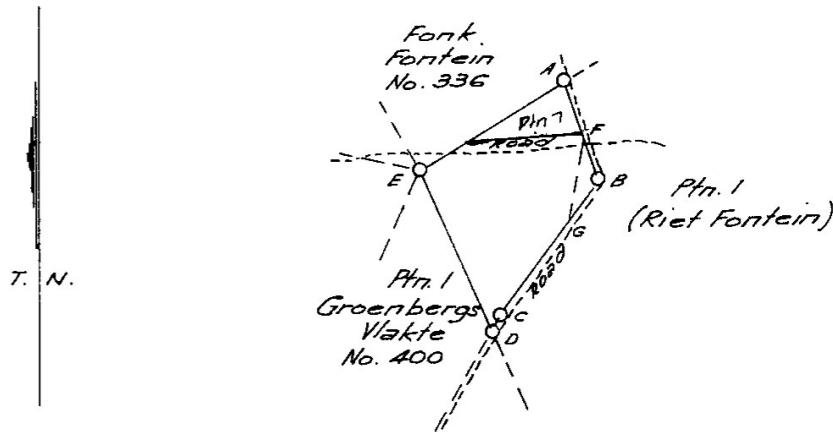

Scale 1:100000

The figure A. B. C. D. E.

represents 579.2415 morgen of land, being

Portion 5 of the farm Platfontein

situate in the

Administrative District of Beaufort West Province of Cape of Good Hope

Surveyed in August 1967 by me

[Signature]
Land Surveyor.

This diagram is annexed to

27 No. 26601/68

dated

i.f.o.

Registrar of Deeds.

The original diagram is

No. 8353/1967

Transfer/Grant

No.

File No. 5/12/94.

S.R. No. E.2316/67.

Comp. DL-7, ~~DL-7~~

Gen. Plan

THE FOLLOWING INFORMATION HAS BEEN MADE FROM THIS DIAGRAM					
SURVEY RECORD	DIAGRAM NO.	AREA 44750 M.	TRANSFER NO.	INITIALED	REMR.
E.1525/87	4066/87	Pm 7.	78,2070	69502/88	BK